



**PROPERTY INFORMATION**

APN:303-55-314  
 MCR # 052418  
 Property Type: Residential  
 Property Address:  
 2646 E ELMWOOD PL  
 CHANDLER, AZ 85249-3580  
 Maricopa County  
 Current Owner  
 PETER R & JOANN M CLARK JR  
 Tax Mailing Address  
 2646 E ELMWOOD PL  
 CHANDLER, AZ 85249-3580

Legal Class:  
 OWNER OCCUPIED RESIDENTIAL

Subdivision:  
 RIGGS RANCH MEADOWS  
 Twn: 2S / Rng: 5E / Sec: 25  
 Block: / Lot: 89  
 Census Tract: 813500 Block: 1002  
 Lat: 33.228216 Lon: -111.795271  
 Legal Description:  
 RIGGS RANCH MEADOWS MCR 524-18

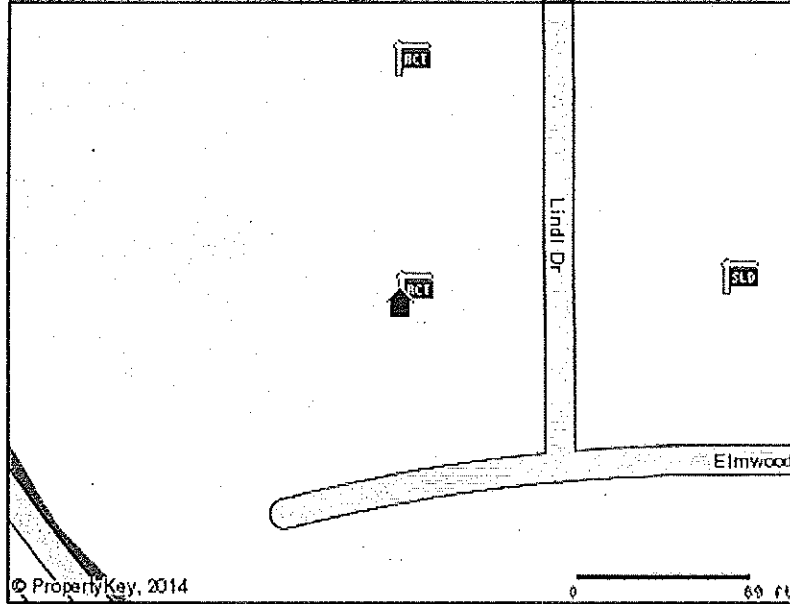

Active 
  Under Contract 
  Sold 
  Pending 
  Cancelled 
  Expired

**LAND AREAS**

1. SFR GRADE 010-4 URBAN SUBDIV	County Zoning: PAD / PLANNED AREA DEVELOPMENT (CM & RD USES) (100.00%)
Lot Size: 0.3 acres (13,048 sf)	City Zoning: PAD / PLANNED AREA DEVELOPMENT (CM & RD USES) (100.00%)

**SUBDIVISION DETAILS FOR RIGGS RANCH MEADOWS**

Improved Lots: 252	With Pool: 172 (68.3%)	1 story: 91	3 story: 0	Average House Size	
Year Built Range: 2001 to 2007		2 story: 161	4 story: 0	3,605 sf	0 rooms 12 fixtures

**TAX VALUATION INFORMATION (TAX AREA = 800306)**

	2011 Final	2012 Final	2013 Final	2014 Prelim	2015 Prelim
Full Cash Improved:	\$214,100	\$198,900	\$188,900	\$217,500	\$263,800
Full Cash Land:	\$53,500	\$49,700	\$47,200	\$54,300	\$65,900
Full Cash Total:	\$267,600	\$248,600	\$236,100	\$271,800	\$329,700
Percent Change:	- n/a -	-7.1%	-5.03%	15.12%	21.3%
Limited Full Cash:	\$267,600	\$248,600	\$236,100	\$259,710	\$272,696
Total Assessed Value:	\$26,760	\$24,860	\$23,610	\$27,180	\$32,970
State Aid Credit:	\$378.54	\$0.00	\$0.00	\$0.00	\$0.00
Tax Amount:	\$2,428.12	\$2,406.38	\$2,361.94	- n/a -	- n/a - County Treasurer

**SALES INFORMATION**

Deed Type	Sale Date	Price	Down	Mtg Amt	Financing	Document #
WARRANTY DEED	03/20/2013	\$385,000	\$81,000	\$304,000	Fannie Mae	130252507
Buyer: PETER R & JOANN M CLARK JR		Seller: DENISE C & TIMOTHY R DONOVAN		Mtg Company: SIERRA PACIFIC MORTGAGE SERVICES INC		
SPECIAL WARRANTY DEED	08/27/2004	\$324,857	\$65,007	\$259,850	Fannie Mae	040999533
Buyer: DENISE C & TIMOTHY R DONOVAN		Seller: COURTLAND HOMES INC		Mtg Company: COLONIAL NATIONAL MORTGAGE		

**BUILDING INFORMATION**

1. SFR GRADE 010-4 URBAN SUBDIV	Rooms: 0	Fixtures: 14	Living Area: 4,060 sf	Built: 2004	Stories: 2.0
Class: CLASS R4, ABOVE AVERAGE	Construction: Wood Frame	Patios: 1 - COVERED			
Quality:	Pool: Yes (400 sf)	Covered Parking: Garage - 3 cars			
Roof Material: Concrete Tile	Added Value: None	Land Premium: None			

Heat: Y

A/C: Refrigeration

Added Area: None

Builder: COURTLAND HOMES

© iMap, Inc, 2014 | Information is believed accurate but not guaranteed and should be independently verified.  
[User Guide](#) | [Tax Data Availability](#) | [Click here to enter a support request](#) or call toll free 800-208-1210

 Powered by  
PropertyKey

4060 29 A

Search Parameters: Property type Residential; Status of 'Active', 'Cancelled', 'Closed', 'Expired', 'Pending', 'Temp Off Market', 'UCB (Under Contract-Backups)'; Dwelling Type of 'Single Family - Detached'; Off Market Date between '04/7/2014' and '10/7/2024'; Subdivision like 'riggs ranch'; Assessor's Book # between 303 and 303.

MLS #	Status	Address	Price	Off Market Date	Close of Escrow Date	Short Address	Year Built	Encoded Features	# of Interior Levels	Approx SQFT	Original List Price	Sold Price	List/Sold Price Sqr	Agent Days on Market	Cumulative DOM	Approx Lot SqFt	Subdivision	
1	5147110	Active	5429 S Scott PL	\$319,000		5429 S Scott PL	2001	42.5RPO3G	2	2,666	335,000		119.65 / NA	78	78	8,008	Riggs Ranch Meadows	
2	5155684	Active	5460 S SCOTT PL	\$338,900		5460 S SCOTT PL	2002	43.5FRO3G	2	3,517	349,900		96.36 / NA	60	60	7,339	Riggs Ranch Meadows	
3	5112652	Active	2768 E TEAKWOOD PL	\$344,900		2768 E TEAKWOOD PL	2003	43FRO3G3S	2	3,517	359,900		98.07 / NA	152	152	7,460	Riggs Ranch Meadows	
4	5164289	Active	2718 E TEAKWOOD PL	\$369,900		2718 E TEAKWOOD PL	2003	53.5RDO3G4S	2	4,015	369,900		92.13 / NA	40	39	7,484	Riggs Ranch Meadows	
5	5171600	Active	2939 E CEDAR PL	\$370,000		2939 E CEDAR PL	2004	53FRDPSO3G3S	2	3,517	370,000		105.2 / NA	22	22	9,100	Riggs Ranch Meadows	
6	5122959	Active	2646 E ELMWOOD PL	\$374,900		2646 E ELMWOOD PL	2004	54FRPO3G	2	4,060	398,900		92.34 / NA	130	130	13,048	RIGGS RANCH MEADOWS	
7	5177820	Active	2990 E Cedar PL	\$475,000		2990 E Cedar PL	2004	53FRPS3G3S	2	3,517	475,000		135.06 / NA	8	8	15,997	Riggs Ranch Meadows	
8	5135333	Active	2680 E CEDAR PL	\$485,000		2680 E CEDAR PL	2004	53.5FRDPO3G4S	2	4,301	485,000		112.76 / NA	105	105	12,253	Riggs Ranch Meadows	
9	5167892	UCB (Under Contract-Backups)	2853 E BIRCHWOOD PL	\$397,500		2853 E BIRCHWOOD PL	2001	53.5FRDXPO3G	2	4,015	397,500		99 / NA	32	31	11,580	Riggs Ranch Meadows	
10	5062541	Pending	2900 E CEDAR PL	\$387,900	07/12/2014	2900 E CEDAR PL	2004	53.5FRDXPSLO3G3S	2	4,015	412,900		96.61 / NA	156	156	8,201	Riggs Ranch Meadows	
11	5165053	Pending	2681 E Beechnut PL	\$669,000	09/12/2014	2681 E Beechnut PL	2002	53.5FRDXPO3G6S	2	3,841	669,000		174.17 / NA	12	12	20,150	Riggs Ranch Meadows	
12	5135016	Closed	2914 E BIRCHWOOD PL	\$329,000	07/02/2014	07/30/2014	2914 E BIRCHWOOD PL	2001	32FRPO3G	1	2,356	339,000	329,000	143.89 / 139.64	9	9	6,000	Riggs Ranch Meadows
13	5066304	Closed	2695 E ELMWOOD PL	\$340,000	08/26/2014	09/26/2014	2695 E ELMWOOD PL	2002	53FRDO3G3S	2	3,517	369,900	340,000	96.64 / 96.67	200	200	7,150	RIGGS RANCH MEADOWS
14	5084335	Closed	2775 E ELMWOOD PL	\$363,000	04/14/2014	05/19/2014	2775 E ELMWOOD PL	2002	53FRDPO3G	2	3,517	379,900	363,000	105.17 / 103.21	31	31	7,278	RIGGS RANCH MEADOWS
15	5070314	Closed	2883 E BIRCHWOOD PL	\$365,000	04/16/2014	04/15/2014	2883 E BIRCHWOOD PL	2001	53FRDXPO3G	2	3,517	379,900	365,000	108.02 / 103.78	61	144	9,232	Riggs Ranch Meadows
16	5121153	Expired	2737 E TEAKWOOD PL	\$329,900	08/25/2014		2737 E TEAKWOOD PL	2003	43RDXO3G	2	3,517	349,500		93.8 / NA	93	92	7,600	Riggs Ranch Meadows
17	5069009	Expired	2736 E TAURUS PL	\$890,000	09/01/2014		2736 E TAURUS PL	2001	63.5FRDXPO4G	2	5,259	945,000		169.23 / NA	202	390	38,311	CIRCLE G AT RIGGS RANCH
18	5113031	Cancelled	2914 E MAHOGANY PL	\$499,000	08/12/2014		2914 E MAHOGANY PL	2005	43FRDXPSO3G6S	1	3,345	499,000		149.18 / NA	95	95	12,037	Riggs Ranch Meadows

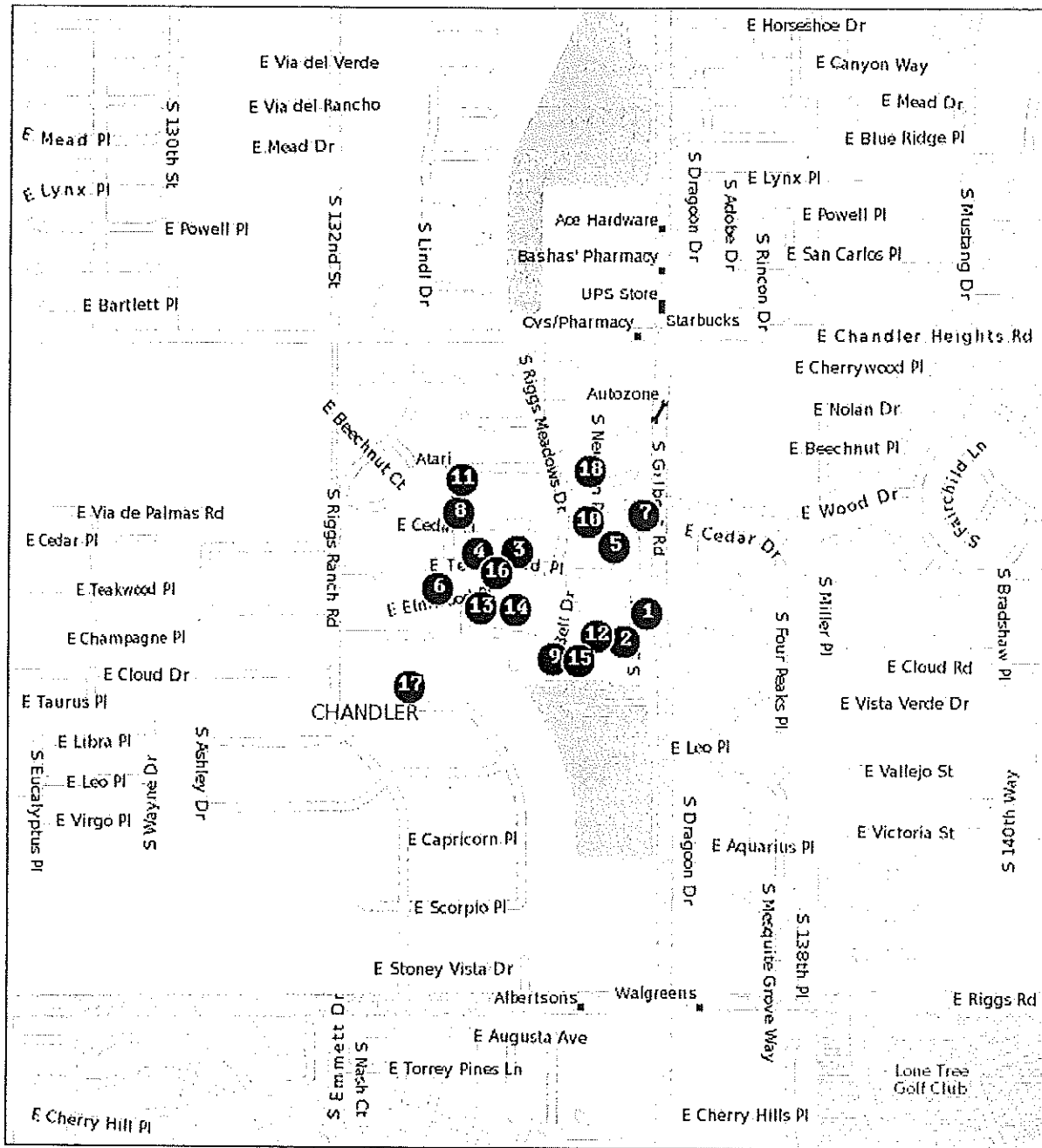

Legend	
1. 5429 S Scott PL Chandler, AZ 85249 (5147110)	10. 2900 E CEDAR PL Chandler, AZ 85249 (5062541)
2. 5460 S SCOTT PL Chandler, AZ 85249 (5155684)	11. 2681 E Beechnut PL Chandler, AZ 85249 (5165053)
3. 2768 E TEAKWOOD PL Chandler, AZ 85249 (5112652)	12. 2914 E BIRCHWOOD PL Chandler, AZ 85249 (5135016)
4. 2718 E TEAKWOOD PL Chandler, AZ 85249 (5164289)	13. 2695 E ELMWOOD PL Chandler, AZ 85249 (5066304)
5. 2939 E CEDAR PL Chandler, AZ 85249 (5171600)	14. 2775 E ELMWOOD PL Chandler, AZ 85249 (5084335)
6. 2646 E ELMWOOD PL Chandler, AZ 85249 (5122959)	15. 2883 E BIRCHWOOD PL Chandler, AZ 85249 (5070314)
7. 2990 E Cedar PL Chandler, AZ 85249 (5177820)	16. 2737 E TEAKWOOD PL Chandler, AZ 85249 (5121153)
8. 2680 E CEDAR PL Chandler, AZ 85249 (5135333)	17. 2736 E TAURUS PL Chandler, AZ 85249 (5069009)
9. 2853 E BIRCHWOOD PL Chandler, AZ 85249 (5167892)	18. 2914 E MAHOGANY PL Chandler, AZ 85249 (5113031)

4060 sq ft

Search Parameters: Property type Residential; Inside the map search Rectangle (-111823720,33233137,-111789216,33219639); Status of 'Active', 'Cancelled', 'Closed', 'Expired', 'Pending', 'Temp Off Market', 'UCB (Under Contract-Backups)'; Dwelling Type of 'Single Family - Detached'; Off Market Date between '04/7/2014' and '10/7/2024'; Assessor's Book # between 303 and 303; Assessor's Map # between 55 and 55; Approx SQFT between 3000 and 5000; # of Interior Levels between 2 and 2.

MLS #	Status	Address	Price	Off Market Date	Close of Escrow Date	Short Address	Year Built	Encoded Features	# of Interior Levels	Approx SQFT	Original List Price	Sold Price	List/Sold Price Sft	Agent Days on Market	Cumulative DOM	Approx Lot SqFt	Subdivision	
1	5155684	Active	5460 S SCOTT PL	\$338,900		5460 S SCOTT PL	2002	43.FRO3G	2	3,517	349,900		96.36 / NA	60	60	7,339	Riggs Ranch Meadows	
2	5112652	Active	2768 E TEAKWOOD PL	\$344,900		2768 E TEAKWOOD PL	2003	43.FRO3G3S	2	3,517	359,900		98.07 / NA	152	152	7,460	Riggs Ranch Meadows	
3	5164289	Active	2718 E TEAKWOOD PL	\$369,900		2718 E TEAKWOOD PL	2003	53.5RDO3G4S	2	4,015	369,900		92.13 / NA	40	39	7,484	Riggs Ranch Meadows	
4	5171600	Active	2939 E CEDAR PL	\$370,000		2939 E CEDAR PL	2004	53.FRDPSO3G3S	2	3,517	370,000		105.2 / NA	22	22	9,100	Riggs Ranch Meadows	
5	5122959	Active	2648 E ELMWOOD PL	\$374,900		2648 E ELMWOOD PL	2004	54.FRPO3G	2	4,060	398,900		92.34 / NA	130	130	13,048	RIGGS RANCH MEADOWS	
6	5142838	Active	2171 E VIRGO PL	\$405,000		2171 E VIRGO PL	2001	53.5FRDPSO3G	2	4,637	440,000		87.34 / NA	88	468	12,463	Barrington	
7	5177820	Active	2990 E Cedar PL	\$476,000		2990 E Cedar PL	2004	53.FRPS3G3S	2	3,517	475,000		135.06 / NA	8	8	15,997	Riggs Ranch Meadows	
8	5135333	Active	2680 E CEDAR PL	\$485,000		2680 E CEDAR PL	2004	53.5FRDPO3G4S	2	4,301	485,000		112.76 / NA	105	105	12,253	Riggs Ranch Meadows	
9	4968944	Active	2622 E BIRCHWOOD PL	\$975,000		2622 E BIRCHWOOD PL	2000	64.5FRDXPQAO4G12S	2	4,745	1,000,000		205.48 / NA	169	169	43,696	Circle G at Riggs Homestead Ranch	
10	5167892	UCB (Under Contract-Backups)	2853 E BIRCHWOOD PL	\$397,500		2853 E BIRCHWOOD PL	2001	53.5FRDXPO3G	2	4,015	397,500		99 / NA	32	31	11,580	Riggs Ranch Meadows	
11	5062541	Pending	2900 E CEDAR PL	\$387,900	07/12/2014	2900 E CEDAR PL	2004	53.5FRDXPSLO3G3S	2	4,015	412,900		96.61 / NA	156	156	8,201	Riggs Ranch Meadows	
12	5165053	Pending	2681 E Beechnut PL	\$669,000	09/12/2014	2681 E Beechnut PL	2002	53.5FRDXPO3G6S	2	3,841	669,000		174.17 / NA	12	12	20,160	Riggs Ranch Meadows	
13	5066304	Closed	2695 E ELMWOOD PL	\$340,000	08/26/2014	09/26/2014	2695 E ELMWOOD PL	2002	53.FRDO3G3S	2	3,517	369,900	340,000	96.64 / 96.67	200	200	7,150	RIGGS RANCH MEADOWS
14	5084335	Closed	2775 E ELMWOOD PL	\$363,000	04/14/2014	05/19/2014	2775 E ELMWOOD PL	2002	53.FRDPO3G	2	3,517	379,900	363,000	105.17 / 103.21	31	31	7,278	RIGGS RANCH MEADOWS
15	5070314	Closed	2883 E BIRCHWOOD PL	\$365,000	04/16/2014	04/15/2014	2883 E BIRCHWOOD PL	2001	53.FRDXP03G	2	3,517	379,900	365,000	108.02 / 103.78	61	144	9,232	Riggs Ranch Meadows
16	5121153	Expired	2737 E TEAKWOOD PL	\$329,900	08/25/2014		2737 E TEAKWOOD PL	2003	43.RDXO3G	2	3,517	349,500		93.8 / NA	93	92	7,600	Riggs Ranch Meadows
17	5051921	Expired	2171 E VIRGO PL	\$439,900	06/09/2014		2171 E VIRGO PL	2001	53.5FRDPSLO3G	2	4,637	445,900		94.67 / NA	152	380	12,463	Barrington
18	5038536	Cancelled	2067 E LIBRA PL	\$419,900	07/17/2014		2067 E LIBRA PL	2001	63.5FRDPSO2G2S	2	4,623	439,000		90.83 / NA	219	219	12,501	BARRINGTON

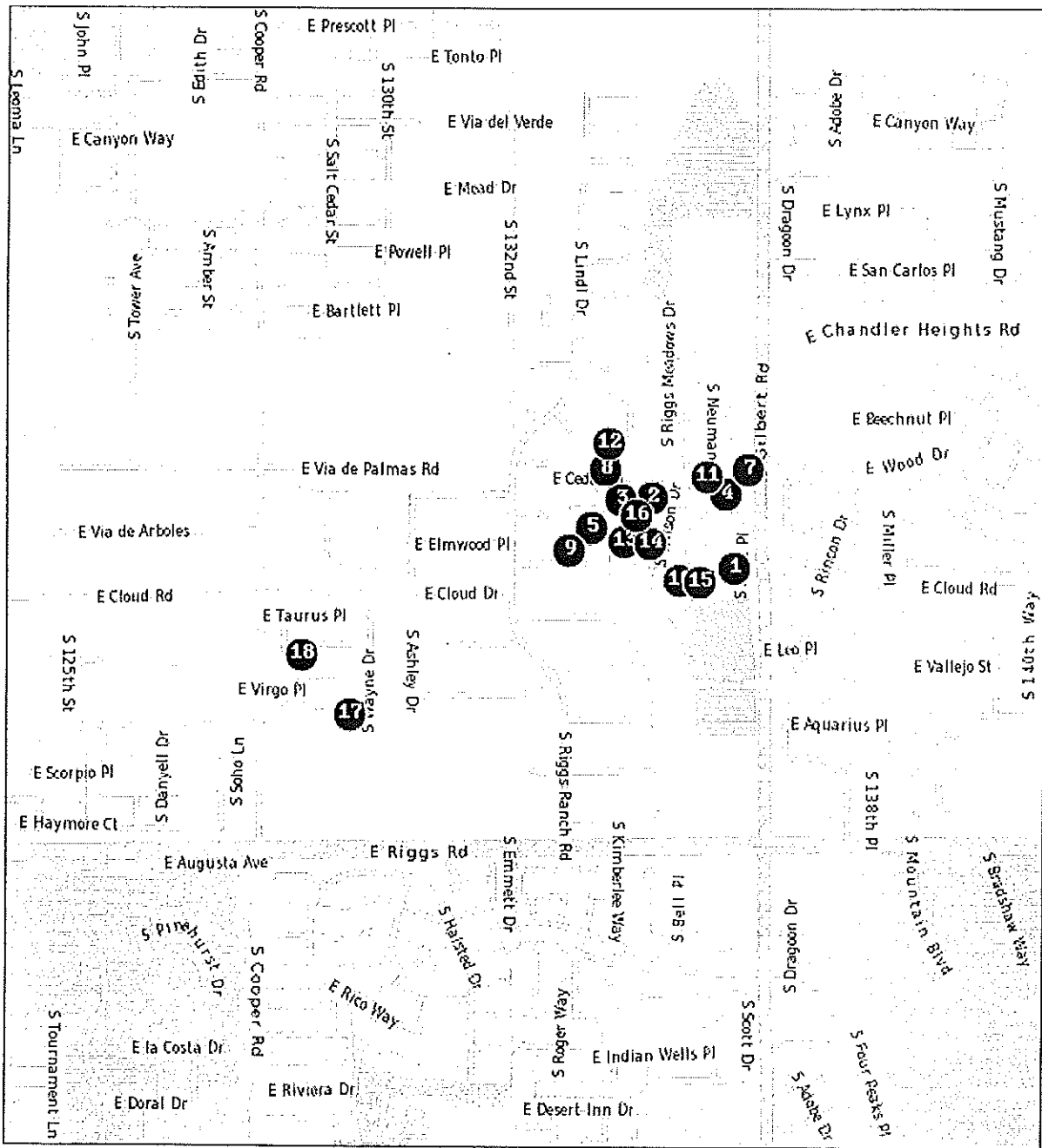

Legend	
1. 5460 S SCOTT PL Chandler, AZ 85249 (5155684)	10. 2853 E BIRCHWOOD PL Chandler, AZ 85249 (5167892)
2. 2768 E TEAKWOOD PL Chandler, AZ 85249 (5112652)	11. 2900 E CEDAR PL Chandler, AZ 85249 (5062541)
3. 2718 E TEAKWOOD PL Chandler, AZ 85249 (5164289)	12. 2681 E Beechnut PL Chandler, AZ 85249 (5165053)
4. 2939 E CEDAR PL Chandler, AZ 85249 (5171600)	13. 2695 E ELMWOOD PL Chandler, AZ 85249 (5066304)
5. 2646 E ELMWOOD PL Chandler, AZ 85249 (5122959)	14. 2775 E ELMWOOD PL Chandler, AZ 85249 (5084335)
6. 2171 E VIRGO PL Chandler, AZ 85249 (5142838)	15. 2883 E BIRCHWOOD PL Chandler, AZ 85249 (5070314)
7. 2990 E Cedar PL Chandler, AZ 85249 (5177820)	16. 2737 E TEAKWOOD PL Chandler, AZ 85249 (5121153)
8. 2680 E CEDAR PL Chandler, AZ 85249 (5135333)	17. 2171 E VIRGO PL Chandler, AZ 85249 (5051921)
9. 2622 E BIRCHWOOD PL Chandler, AZ 85249 (4968944)	18. 2067 E LIBRA PL Chandler, AZ 85249 (5038536)

Search Parameters: Property type Residential; Inside the map search Rectangle (-111823720,33233137,-111789216,33219639); Status of 'Active', 'Cancelled', 'Closed', 'Expired', 'Pending', 'Temp Off Market', 'UCB (Under Contract-Backups)'; Dwelling Type of 'Single Family - Detached'; Off Market Date between '04/7/2014' and '10/7/2024'; Assessor's Book # between 303 and 303; Assessor's Map # between 55 and 55.

MLS #	Status	Address	Price	Off Market Date	Close of Escrow Date	Short Address	Year Built	Encoded Features	# of Interior Levels	Approx SQFT	Original List Price	Sold Price	List/Sold Price Sqrt	Agent Days on Market	Cumulative DOM	Approx Lot SqFt	Subdivisi	
1	5147110	Active	5429 S Scott PL	\$319,000		5429 S Scott PL	2001	42.5RPO3G	2	2,666	335,000		119.65 / NA	78	78	8,008	Riggs Rai Meadows	
2	5155684	Active	5460 S SCOTT PL	\$338,900		5460 S SCOTT PL	2002	43.5FRO3G	2	3,517	349,900		96.36 / NA	60	60	7,339	Riggs Rai Meadows	
3	5112652	Active	2768 E TEAKWOOD PL	\$344,900		2768 E TEAKWOOD PL	2003	43FRO3G3S	2	3,517	359,900		98.07 / NA	152	152	7,460	Riggs Rai Meadows	
4	5164289	Active	2718 E TEAKWOOD PL	\$369,900		2718 E TEAKWOOD PL	2003	53.5RDO3G4S	2	4,016	369,900		92.13 / NA	40	39	7,484	Riggs Rai Meadows	
5	5171600	Active	2939 E CEDAR PL	\$370,000		2939 E CEDAR PL	2004	53FRDPSO3G3S	2	3,517	370,000		105.2 / NA	22	22	9,100	Riggs Rai Meadows	
6	5122959	Active	2646 E ELMWOOD PL	\$374,900		2646 E ELMWOOD PL	2004	54FRPO3G	2	4,060	398,900		92.34 / NA	130	130	13,048	RIGGS RANCH MEADOW	
7	5142838	Active	2171 E VIRGO PL	\$405,000		2171 E VIRGO PL	2001	53.5FRDPSO3G	2	4,637	440,000		87.34 / NA	88	468	12,463	Barrington	
8	5112194	Active	5670 S EUCALYPTUS PL	\$450,000		5670 S EUCALYPTUS PL	2002	53.5FRDX3G3S	1	3,881	465,000		115.95 / NA	153	153	13,944	Barrington	
9	5176748	Active	2207 E LIBRA PL	\$455,000		2207 E LIBRA PL	2001	43.5FRDO3G	1	3,881	455,000		117.24 / NA	11	162	12,679	Barrington	
10	5177820	Active	2990 E Cedar PL	\$475,000		2990 E Cedar PL	2004	53FRPS3G3S	2	3,517	475,000		135.06 / NA	8	8	15,997	Riggs Rai Meadows	
11	5147072	Active	2151 E VIRGO PL	\$475,000		2151 E VIRGO PL	2001	54FRDXPO3G2S	2	5,164	475,000		91.98 / NA	79	79	12,262	Barrington	
12	5135333	Active	2680 E CEDAR PL	\$485,000		2680 E CEDAR PL	2004	53.5FRDPO3G4S	2	4,301	485,000		112.76 / NA	105	105	12,253	Riggs Rai Meadows	
13	5175288	Active	2496 E LIBRA PL	\$774,900		2496 E LIBRA PL	1997	54FRDXPQO4G6S	1	3,845	775,000		201.53 / NA	14	187	37,405	CIRCLE G	
14	5108455	Active	5350 S ASHLEY DR	\$799,850		5350 S ASHLEY DR	1999	54FRDXPSO3G2S	1	4,148	829,000		192.83 / NA	159	159	35,079	Circle G	
15	5105649	Active	2138 E TEAKWOOD PL	\$850,000		2138 E TEAKWOOD PL	2012	53.5FRDXPNO4G	1	4,650	870,000		182.8 / NA	166	166	20,144	Tierra Lin	
16	5177962	Active	2007 E TEAKWOOD PL	\$875,000		2007 E TEAKWOOD PL	2005	53.5RDXPNO4G	1	4,175	875,000		209.58 / NA	8	8	22,665	TIERRA LINDA	
17	4968944	Active	2622 E BIRCHWOOD PL	\$975,000		2622 E BIRCHWOOD PL	2000	64.5FRDXPQAO4G12S	2	4,745	1,000,000		205.48 / NA	169	169	43,696	Circle G a Riggs Homester Ranch	
18	5177753	Active	2087 E TEAKWOOD PL	\$975,000		2087 E TEAKWOOD PL	2005	54.5RDXPNO4G	1	5,139	975,000		189.73 / NA	9	9	20,206	Tierra Lin	
19	5100197	Active	2593 E TEAKWOOD PL	\$979,894		2593 E TEAKWOOD PL	2004	44.5FRDXPO4G	1	4,297	969,900		228.04 / NA	178	177	38,501	Circle G a Riggs Uni	
20	5176296	Active	2066 E Champagne PL	\$990,000		2066 E Champagne PL	2006	53.5FRDXPO4G	1	4,720	990,000		209.75 / NA	12	12	20,141	Tierra Lin	
21	5090337	Active	2490 E Cedar PL	\$1,185,000		2490 E Cedar PL	2001	64FRDXPO4G4S	2	5,631	1,185,000		210.44 / NA	195	195	36,455	Circle G Ranch	
22	5105241	Active	2564 E TEAKWOOD PL	\$1,299,000		2564 E TEAKWOOD PL	2006	65.5FRXPSQO4G3S	1	6,062	1,329,000		214.29 / NA	166	166	35,960	Circle G a Riggs Homester	
23	5178464	Active	2331 E CEDAR PL	\$1,499,000		2331 E CEDAR PL	2007	67RXPO6G6S	1	7,134	1,499,000		210.12 / NA	7	7	36,717	Circle G a Riggs Homester	
24	5167892	UCB (Under Contract-Backups)	2853 E BIRCHWOOD PL	\$397,500		2853 E BIRCHWOOD PL	2001	53.5FRDXPO3G	2	4,015	397,500		99 / NA	32	31	11,580	Riggs Rai Meadows	
25	5147393	UCB (Under Contract-Backups)	2117 E TEAKWOOD PL	\$970,000		2117 E TEAKWOOD PL	2014	54.5RDXPNO4G	1	5,000	1,000,000		194 / NA	78	78	20,204	Tierra Lin	
26	5062541	Pending	2900 E CEDAR PL	\$387,900	07/12/2014	2900 E CEDAR PL	2004	53.5FRDXPSLO3G3S	2	4,015	412,900		96.61 / NA	156	156	8,201	Riggs Rai Meadows	
27	5144354	Pending	2031 E VIRGO PL	\$535,000	09/19/2014	2031 E VIRGO PL	2002	63.5FRDXO4G	2	5,379	449,900		99.46 / NA	67	67	15,748	Barrington	
28	5165053	Pending	2681 E Beechnut PL	\$669,000	09/12/2014	2681 E Beechnut PL	2002	53.5FRDXPO3G6S	2	3,841	669,000		174.17 / NA	12	12	20,150	Riggs Rai Meadows	
29	5034335	Pending	5561 S WILSON DR	\$730,000	10/03/2014	5561 S WILSON DR	1998	43.1FRDXPQ3G4S	1	3,941	800,000		185.23 / NA	266	266	36,678	Circle G a Riggs Homester Ranch Ur	
30	5000705	Pending	2337 E LIBRA PL	\$845,000	09/26/2014	2337 E LIBRA PL	1999	44.5FRDXPSO3G	1	4,107	895,000		205.75 / NA	373	373	37,566	Circle G a Riggs Homester	
31	5135016	Closed	2914 E BIRCHWOOD PL	\$329,000	07/02/2014	07/30/2014	2914 E BIRCHWOOD PL	2001	32FRPO3G	1	2,356	339,000	329,000	143.89 / 139.64	9	9	8,000	Riggs Rai Meadows
32	5066304	Closed	2695 E ELMWOOD PL	\$340,000	08/26/2014	09/26/2014	2695 E ELMWOOD PL	2002	53FRDO3G3S	2	3,517	369,900	340,000	96.64 / 96.67	200	200	7,150	RIGGS RANCH MEADOW

33	5084335	Closed	2775 E ELMWOOD PL	\$363,000	04/14/2014	05/19/2014	2775 E ELMWOOD PL	2002	53FRDPO3G	2	3,517	379,900	363,000	105.17 / 103.21	31	31	7,278	RIGGS RANCH MEADOW
34	5070314	Closed	2883 E BIRCHWOOD PL	\$365,000	04/16/2014	04/15/2014	2883 E BIRCHWOOD PL	2001	53FRDXPO3G	2	3,517	379,900	365,000	108.02 / 103.78	61	144	9,232	Riggs Ran Meadows
35	5119466	Closed	2146 E LIBRA PL	\$445,000	05/27/2014	07/08/2014	2146 E LIBRA PL	2002	43.5FRDPO3G	1	3,881	449,000	445,000	115.69 / 114.66	5	5	12,591	BARRINC
36	5110395	Closed	2562 E SCORPIO PL	\$690,000	08/21/2014	09/29/2014	2562 E SCORPIO PL	1997	33RDXPSHO4G3S	1	3,056	749,000	690,000	226.44 / 225.79	110	109	34,857	CIRCLE C HOMEST RANCH
37	5157734	Closed	2561 E BIRCHWOOD PL	\$792,000	08/14/2014	09/16/2014	2561 E BIRCHWOOD PL	2002	53.5RDXPSO3G6S	1	4,000	809,900	792,000	202.48 / 198	150	144	35,242	CIRCLE C RIGGS HOMEST RANCH L 5
38	5052480	Closed	2372 E ELMWOOD PL	\$980,000	06/26/2014	06/25/2014	2372 E ELMWOOD PL	2003	43.5FRDXPSO4G12S	1	4,900	1,025,000	980,000	201.84 / 200	168	167	38,852	Circle G
39	5027681	Closed	2594 E TEAKWOOD PL	\$989,000	06/27/2014	07/29/2014	2594 E TEAKWOOD PL	2001	43.5FRDXPSO4G4S	1	5,164	1,199,000	989,000	208.56 / 191.52	231	231	38,984	Circle G
40	4997364	Closed	25117 S 134TH PL	\$1,155,000	05/07/2014	06/03/2014	25117 S 134TH PL	2006	74.5RDXPSQO3G	1	5,461	1,549,000	1,155,000	237.87 / 211.5	238	238	35,341	None
41	5121153	Expired	2737 E TEAKWOOD PL	\$329,900	08/25/2014		2737 E TEAKWOOD PL	2003	43RDXO3G	2	3,517	349,500		93.8 / NA	93	92	7,600	Riggs Ran Meadows
42	5051921	Expired	2171 E VIRGO PL	\$439,900	06/09/2014		2171 E VIRGO PL	2001	53.5FRDPSLO3G	2	4,637	445,900		94.87 / NA	152	380	12,463	Barrington
43	5105174	Expired	2207 E LIBRA PL	\$459,900	09/22/2014		2207 E LIBRA PL	2001	43.5RDXO3G	1	3,881	479,000		118.5 / NA	151	151	12,679	BARRINC
44	5069009	Expired	2736 E TAURUS PL	\$890,000	09/01/2014		2736 E TAURUS PL	2001	63.5FRDXPO4G	2	5,259	945,000		169.23 / NA	202	390	38,311	CIRCLE C RIGGS RANCH
45	5098366	Expired	2543 E SCORPIO PL	\$1,350,000	09/21/2014		2543 E SCORPIO PL	1996	66.5FRDXPSQA03G	2	7,813	1,350,000		172.79 / NA	165	164	59,237	Circle G a Riggs Homeste
46	5053558	Expired	2527 E BEECHNUT CT	\$1,875,000	06/14/2014		2527 E BEECHNUT CT	2001	55.5FRDXPSQO3G	2	7,200	1,875,000		260.42 / NA	152	152	36,124	CIRCLE C RIGGS HOMEST
47	5038536	Cancelled	2067 E LIBRA PL	\$419,900	07/17/2014		2067 E LIBRA PL	2001	63.5FRDPSO2G2S	2	4,623	439,000		90.83 / NA	219	219	12,501	BARRINC
48	5113031	Cancelled	2914 E MAHOGANY PL	\$499,000	08/12/2014		2914 E MAHOGANY PL	2005	43FRDXPSO3G6S	1	3,345	499,000		149.18 / NA	95	95	12,037	Riggs Ran Meadows
49	5063912	Cancelled	2561 E BIRCHWOOD PL	\$809,900	06/27/2014		2561 E BIRCHWOOD PL	2002	53.5RDXPSO3G6S	1	4,000	850,000		202.48 / NA	144	144	35,242	CIRCLE C RIGGS HOMEST RANCH L 5
50	5095148	Cancelled	2496 E LIBRA PL	\$810,000	09/24/2014		2496 E LIBRA PL	1998	54FRDXPO4G6S	1	3,845	819,900		210.66 / NA	174	174	37,405	CIRCLE C RIGGS HOMEST RANCH
51	4988069	Cancelled	5440 S ASHLEY DR	\$825,000	08/22/2014		5440 S ASHLEY DR	2000	43.5FRDXPO3G6S	1	4,368	899,900		188.01 / NA	364	364	36,539	Circle G a Riggs Homeste
52	5071445	Cancelled	2007 E TEAKWOOD PL	\$875,000	06/26/2014		2007 E TEAKWOOD PL	2005	53.5RDXPSO4G	1	4,175	899,999		209.58 / NA	129	129	22,665	TIERRA LINDA
53	5165607	Cancelled	2331 E CEDAR PL	\$1,535,000	09/09/2014		2331 E CEDAR PL	2007	67RXP06G6S	1	7,332	1,535,000		209.36 / NA	7	333	36,717	Circle G a Riggs Homeste
54	5095134	Cancelled	2331 E CEDAR PL	\$1,539,000	08/08/2014		2331 E CEDAR PL	2007	66.5FRXP06G	1	7,332	1,578,000		209.9 / NA	110	326	36,717	Circle G a Riggs Homeste